



Map



August 2018



Welcome

Join the Museum

Members help support exhibitions and programs while enjoying great benefits.

Become a member to receive free admission to ticketed exhibitions as well as discounts on parking and in the store and café.

Museum Store

The museum store offers a variety of art-related products both in the museum and through an online store. Hours match those of the museum.

Join us in preserving art for the future—please do not touch the works of art.

Why? Believe it or not, even the oils from your skin will cause severe lasting damage to artworks over time. Help preserve these masterworks for future generations by using your eyes, ears, minds, and voices—but not your fingers! Thank you.

www.ClevelandArt.org
11150 East Boulevard, Cleveland, OH 44106
216-421-7340, 888-CMA-0033

Visitor Services

Hours

Tuesday, Thursday, Saturday, Sunday
10:00 a.m.–5:00 p.m.

Wednesday, Friday
10:00 a.m.–9:00 p.m.

Closed Mondays except Martin Luther King Jr. Day
10:00 a.m.–5:00 p.m.

Closed January 1, July 4, Thanksgiving Day, and December 25

Daily tours

Public tours are offered daily. Please visit the atrium desk for more information.

Touch tours for visitors who are blind or partially sighted are available with advance notice. Register at access@clevelandart.org.

Ticket Center

Admission to the permanent collection galleries is free. Special exhibitions, performances, films, and programs may require an admission fee.

Ingalls Library

Tuesday–Friday
10:00 a.m.–5:00 p.m.
Reference desk:
216-707-2530

ArtLens App and help desk

Download the ArtLens App (use with any iOS or Android device) to find yourself anywhere in the museum and to find any work of art on view. For help downloading and using the ArtLens App or to rent a preloaded device, stop by the ArtLens Gallery help desk.

Provenance Café

Tuesday, Thursday, Saturday, Sunday
10:00 a.m.–4:30 p.m.

Wednesday, Friday
10:00 a.m.–8:00 p.m.

Provenance Restaurant

Sunday 11:00 a.m.–3:00 p.m.
Lounge 11:00 a.m.–4:30 p.m.

Tuesday, Thursday, Saturday
11:30 a.m.–2:00 p.m.
Lounge 11:30 a.m.–3:00 p.m.

Wednesday, Friday
11:30 a.m.–2:00 p.m. and
5:00–8:00 p.m.
Lounge 11:30 a.m.–8:30 p.m.

Restrooms and drinking fountains

Located throughout the museum. Please refer to map symbols for locations.

Lost & Found

Unclaimed items are turned in at the coat check in the north lobby (level one). Lost & Found can be reached at 216-707-2275.

Accessibility

All areas of the museum are accessible to visitors who need to avoid stairs.

Wheelchairs and strollers

A limited supply is available at the coat check in the north lobby (level one).

Wheelchairs have been generously provided by



Backpacks, bags, purses, and umbrellas

Please check all bags, backpacks, briefcases 13 x 17 x 6 inches or larger, umbrellas, and other bulky items. All items are subject to inspection and the museum reserves the right to decide what should be checked. Nothing is permitted to be carried on one's back.

ATM

Our ATMs, located in the north lobby and in the atrium, accept several major brand cards. A transaction fee applies.

Parking garage

Hourly rates apply. See ticket center for more information, including member discounts.

Vehicle assistance

Notify visitor services at the north lobby information desk.

Food and drinks are not permitted in the galleries.

The CMA is a smoke-free environment.

Outside food and drinks are not permitted.

Photography without a flash

is permitted for noncommercial purposes of objects from the museum's permanent collection. Photography is NOT permitted of works of art on loan, under copyright, or in special exhibitions. Flash photography, tripods, monopods, selfie sticks, and video cameras are also not permitted.

Level two



SOUTH GALLERIES

- 200 Rotunda
- 201-202 Neoclassical
- 203 British
- 204-208 American
- 209 Tiffany
- 210 Armor Court
- 211 Fabergé
- 212, 214-215, 217 Baroque
- 213 Dutch
- 216 Late Baroque
- 301 Collector's Cabinet

NORTH GALLERIES

- 231 Native North American
- 232-233 Ancient American
- 234 Textiles
- 235-236 Japanese and Korean
- 237 Himalayan

EAST GALLERIES

- 224a, 229 Contemporary
- 224b Video Project Room
- 218-221, 223, 225-226 Modern
- 222 Impressionism
- 227 Abstract Expressionism
- 228 Cleveland Gallery
- 230 Photography

WEST GALLERIES

- 238-241 Chinese
- 242-244 Indian and Southeast Asian

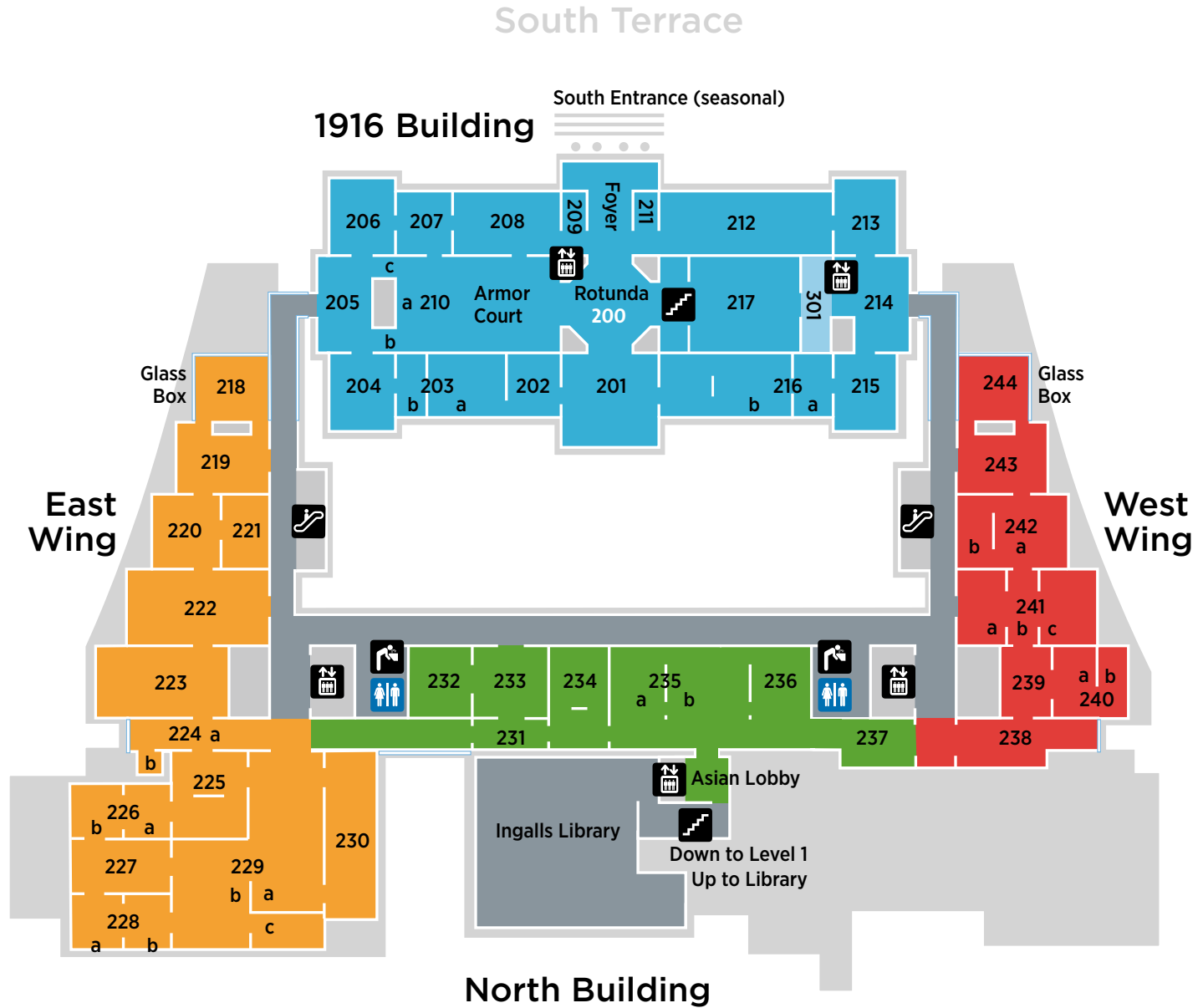

Level one



SOUTH GALLERIES

- 100** 1916 lobby
- 101** Prints and Drawings
- 102-103** Ancient Near Eastern, Greek, and Roman
- 104-105** Early Christian and Byzantine
- 106** Medieval
- 107** Ancient Egyptian
- 108** African
- 109-111** Late Medieval
- 112** Northern Renaissance

- 113** French Tapestries and Illuminated Manuscripts
- 114** German Painting and French Decorative Art
- 115** Rotating Textiles and Manuscripts
- 116** Islamic
- 117** Early Italian Renaissance
- 118** Italian Renaissance

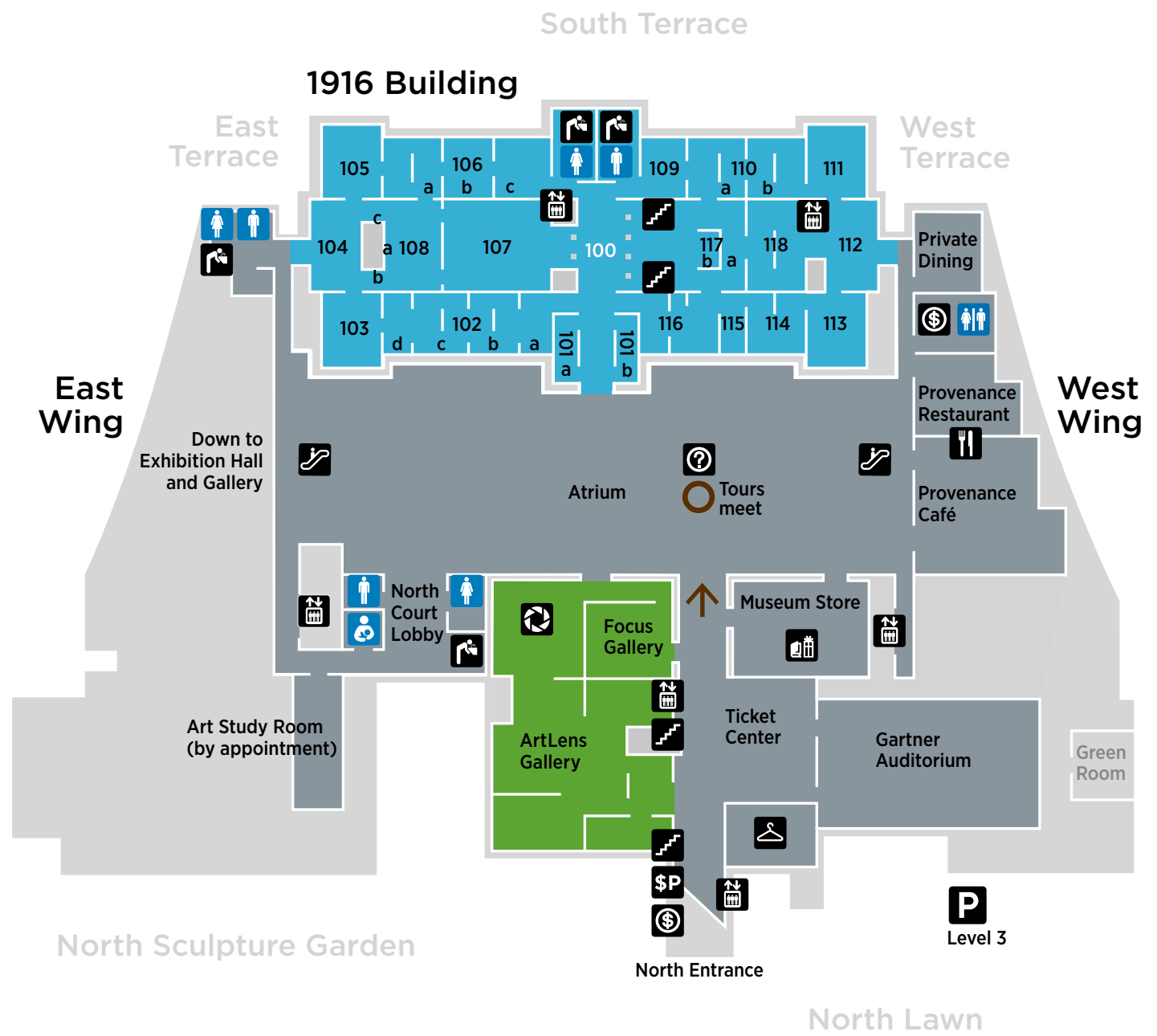

www.ClevelandArt.org
 11150 East Boulevard, Cleveland, OH 44106
 216-421-7340, 888-CMA-0033

August 2018

Lower Level



- 000 Education lobby
- 001 Exhibition lobby

Key

- Parking pay station
- ATM (cash)
- Restaurant and Café
- Coat check
- Drinking fountain
- Elevator
- Escalator
- Stairs
- Information
- Museum store
- Parking
- Restrooms
- Family room
- Nursing room
- Tours meet
- Help desk & mobile device rental

